

Sai Srinivasa Nagar Kesarapalli Phase - 3 Lay out Plan

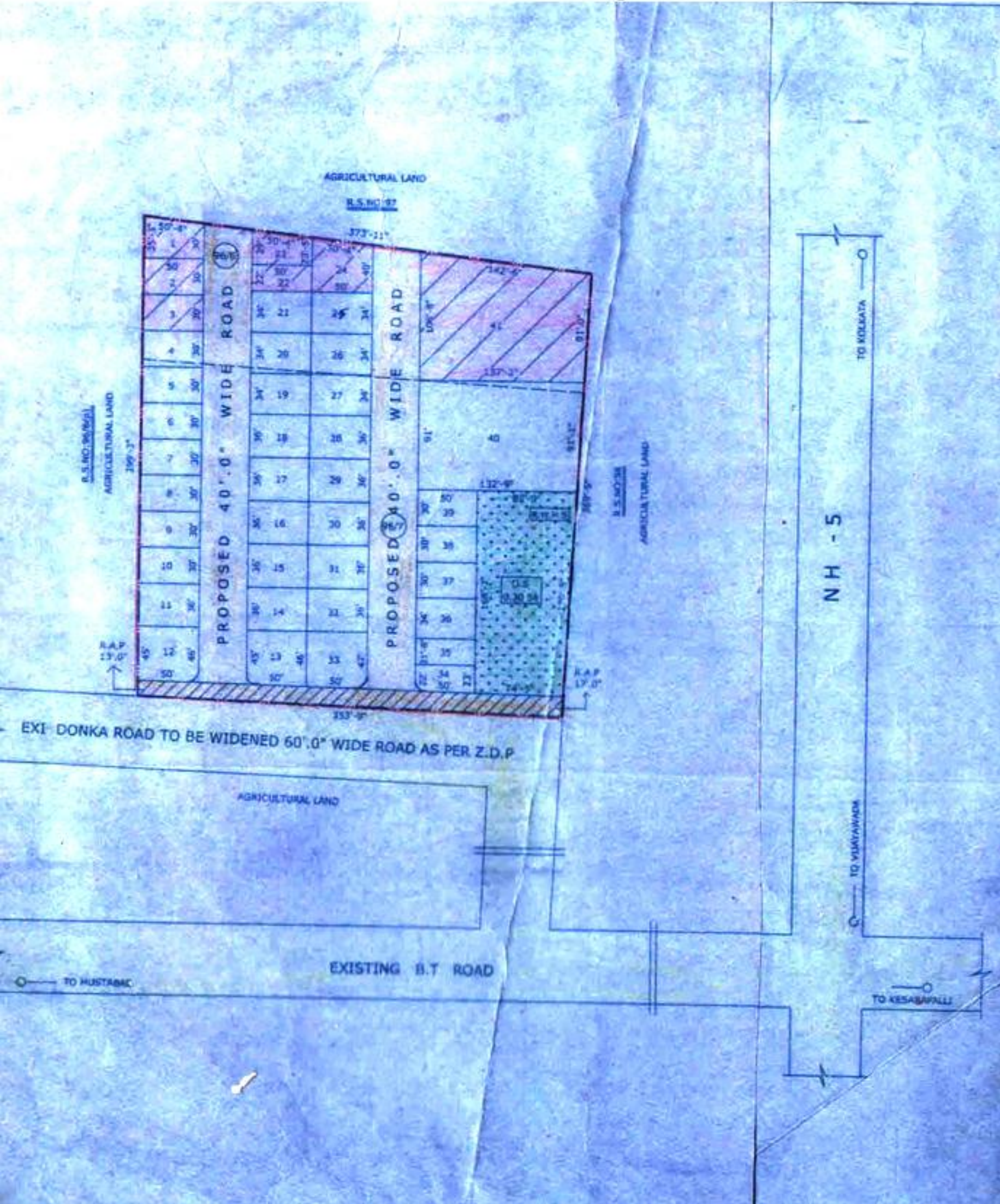

| | |
|-----------------------------------------------------------------------------------------------------------|---------------------------------------|
| L.P.NO : 13/2009/VJA. | |
| FILE NO : RC - C2 - 1158/2009. (WITH MORTGAGE) | |
| LAY-OUT PLAN IN R.S.NO : 96/6(P), 7; OF KESARAPALLI VILLAGE IN GANNAVARAM MANDAL, KRISHNA DISTRICT. | |
| REFERENCE | |
| BOUNDARY OF THE PROPOSED LAY-OUT : | |
| BOUNDARY OF THE SUB-DIVISION : | |
| AREA OF THE LAY-OUT : | Ac 3.05 00 Cents |
| % OF OPEN SPACE (10.00%) : | Ac 0.30 50 Cents |
| % OF ROADS AREA (31.15%) : | Ac 0.95 00 Cents |
| PROPOSED ROADS : | |
| EXISTING ROADS : | |
| ROAD AFFECTED PORTION : | |
| NUMBER OF PLOTS : | 41 |
| TOTAL PLOTTED AREA : | Ac 2.10 00 Cents |
| MORTGAGE PLOTTED AREA (25% ON TOTAL PLOTTED AREA) : | Ac 0.52 50 Cents |
| MORTGAGE PLOT NUMBER'S : | 1, 2, 3, 22, 23, 24, 41. |
| SPALY AT 60'.0" WIDE ROAD JUNCTIONS : | 5M X 5 Metres |
| RAIN WATER HARVESTING STRUCTURE : | R.W.H.S. 2.00 X 1.50 X 1.50 Metres |
| V.G.T.M URBAN DEVELOPMENT AUTHORITY,VJA. | |
| | SH. Y. S. PRASAD VICE CHAIRMAN |
| | CHIEF PLANNING OFFICER |
| | PLANNING OFFICER |
| | ASST. PLANNING OFFICER |
| | JUNIOR PLANNING OFFICER |
| SCALE 1" : 66'.0" | |