



Gates of Splendour

The lifestyle of your dreams





We are proud to announce the long awaited venture
"Sai Krishna Township"
by renowned builders **Krushna Sai Housing Pvt. Ltd.**



Background of the Builders

Completed Projects :

Sri Krishna Towers, Penamaluru | **Sai Maruthi Nagar**, Gudavalli
Sai Srinivasa Nagar, Kesarapalli Phase 1, Phase 2 & Phase 3
Venkatadri Gardens, Penamaluru | **Sai Ganesh Nagar**, Kankipadu
Narayanadri Gardens, Neppalli

Ongoing Projects:

Sai Satya Dev Nagar, Neppalli
SKS Mega Township, Kakinada
[A world class gated community]



Sri Krishna Towers, Penamaluru



Sai Srinivasa Nagar, Phase 1, 2 & Phase 3
Kesarapalli



SKS Mega Township, Kakinada



SAI Satya Dev Nagar, Neppalli



Sai Krishna Township is ideally located in the fast growing Real Estate Business HUB, KESARAPALLI, adjacent to the lush green suburb Gannavaram. This high growth area is very close to Vijayawada, on NH5, connecting Chennai and Calcutta.

The luxuriant tropical climate, clean environment and serene atmosphere provide a haven for people of all ages from all walks of life.

Gannavaram Airport is well connected to major cities, and expected to become an international airport. It caters to a wide range of passengers, particularly traders, professionals, students and NRI's.

This is now the most happening town near Vijayawada, driven by major real estate development. It features an upcoming IT Hub, the much-hyped Information Technology Park, with over 1.75 lakh square feet built-up area in 'Medha Tower' at Kesarapalli, just 0.3 km from NH-5.

Get your choice piece of this real estate today, before it's too late. Be early to be lucky!

Sai Krishna Township *Independent – Duplex Villas*

Near NH-5 Road 0.2 km | 0.3 km L&T IT Park | 0.3 km N.T.R College of Veterinary | 1.5 km Gannavaram AIR PORT | 1.5 km Chaitanya Techno School | 2km Eenadu Paper Industry | 2km Skoda Benz Car Showroom | 2.5km Varun Motors | 2.5 km Gowtham KKR International School | 2.5km SPA College | 3.5 km St. John's School | 3.5 km Narayana & Chaitanya Colleges | 3.5 km Gannavaram Bus-Stand | 4 km Gannavaram Railway Station | 5km Pinnamaneni Medical College & Hospital | 6km Best Price Super Market | 6 km Delhi Public School



East Face Duplex





← GROUND FLOOR PLAN

FIRST FLOOR PLAN ▲



Ground Floor Area : 850 sq. ft
 First Floor Area : 850 sq. ft
 Total : 1700 sq. ft
 Plot Area : 222 sq. yd



West Face Duplex





GROUND FLOOR PLAN

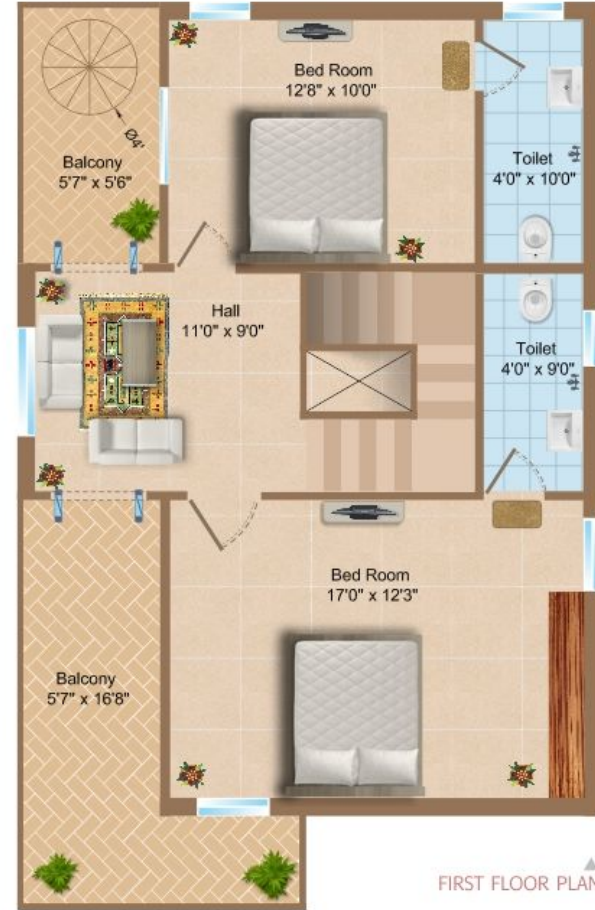

FIRST FLOOR PLAN



Ground Floor Area : 850 sq. ft
 First Floor Area : 850 sq. ft
 Total : 1700 sq. ft
 Plot Area : 222 sq. yd



East Face Independent House



TYPICAL FLOOR PLAN



Built up Area : 1200 sq.ft
Plinth Area : 800 sq.ft
Plot Area : 200 sq.yd



West Face Independent House



Built up Area : 1200 sq.ft
Plinth Area : 800 sq.ft
Plot Area : 200 sq.yd



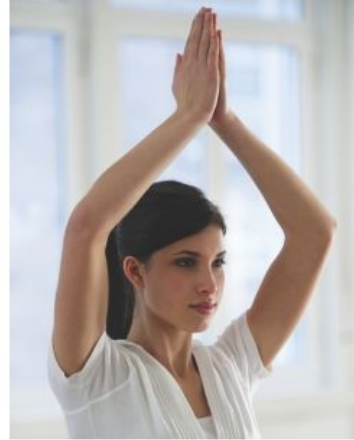
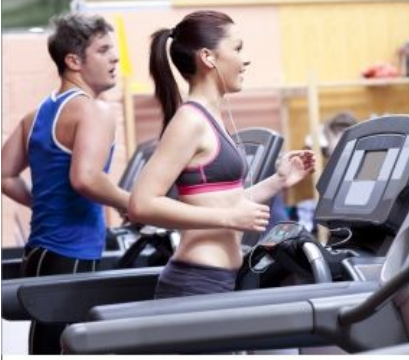

Amenities

- Mini auditorium
- Gym
- Children`s play area and park
- Drinking water plant (R.O)
- Overhead water tank
- Compound wall with solar fencing for entire layout
- 24 hrs security monitoring with CC TV cameras
- Street lights
- Power supply
- Covered drainage
- Shopping area
- C.C.Roads (or) B.T Roads
- Gateway

BANK LOAN AVAILABLE

Specifications

Foundation & Structure	RCC framed structure with G+1 floor pile foundation designed structural engineers.
Super Structure	Table moulded clay bricks in cement mortar (Ratio 1:6). External wall 9" and Inner walls 4 1/2" plastering of walls cement mortar (Ratio 1:5) of 1/2" thickness.
Basement Height	4' from ground level (filled with filling material).
Slab Height	10'-6" height from the basement level.
Main Door & Window	Main door and main windows of teak wood frame (4"x3") with teak wood shutters with wooden polish and brass fittings and smoke glasses.
Other Doors & Windows	Other door (4"x3") with teak wood frames and teak shutters with standard power coated aluminum fittings and teak wood frame and shutter frames with white pin headed glass panels and ornamental MS safety grills for windows, with enamel paint.
Flooring	2' x 2' Vitrified tiles flooring with skirting.
Toilets, Plumbing & Drainage	<ul style="list-style-type: none"> a) Toilet flooring with anti skid ceramic tiles. b) Dado with glazed tiles up to door level. c) One white colour floor mounted E.W.C and Indian type one Orissa pan will be provided with PVC flush tanks. d) Two White medium size wall mounted wash basins will be provided with necessary fittings one in dining area. e) One head shower provided with wall mixer for each bathroom. f) All water lines with CPVC pipes. g) Toilet door teak wood frame with bisan panel, and other side covered with PVC sheet. h) All drainage system with SOIR pipes. i) Branded Taps (Jaguar, Johnson, Dhara, Hindware).
Painting	<ul style="list-style-type: none"> a) Internal Walls : Wall care finish with Emulsion paint over a coat of cement primer (white). b) External Walls : Emulsion paint over a coat of cement primer (colors by architect). c) Elevation Part Wall care : Wood work and M.S. Work will be painted with synthetic enamel paints. (Except main door and window)
Electrical	Concealed standard copper wiring with best quality MCB's, modular switches, power plugs for a/c, geyser, mixer and refrigerator. Concealed wiring for telephone (two points), TV cable line (one point) branded, switches (Legrand, Levon, G.M, Salzer, Etc.,).
Pop Borders	POP borders will be provided inside hall, bedrooms and study rooms (pop ceiling will cost extra)
Kitchen	Granite kitchen platform with stainless steel sink, up to door height dado with ceramic designer tiles above platform.
Loft (sajja)	One loft will be provided (1 meter width) in the kitchen or toilet.
Stair Case Railing	S.S. Railing will be provided with inside stair case. M.S. Spiral Steps will be provided with outside stair case (No head rooms).
Washing Platform	Washing platform with C.C. Bed will be provided with tap.
Wardrobe sizes	Bed Rooms : 6' x 6'.9" Kitchen : 7' x 6'.9" Hall Showcase : 6' x 6'.9" Dining : 6' x 3'

Deluxe - Specifications

Pop Ceiling Plain (Plaster of Paris) | Modular Kitchen (Stove, Chimney, Stainless Steel Wash Basin)
 Inverter Wiring | Air-Conditioning two Bedrooms | Cupboard Facility in Hall |
 Two Bedrooms | Kitchen | Dining Hall | Flooring for the area covered under slab projection

Note : The builders may change the specifications during any stage of construction and their decision shall be final.
 Any change in the drawings and specifications will cost extra.



Location Plan *(Not to Scale)*

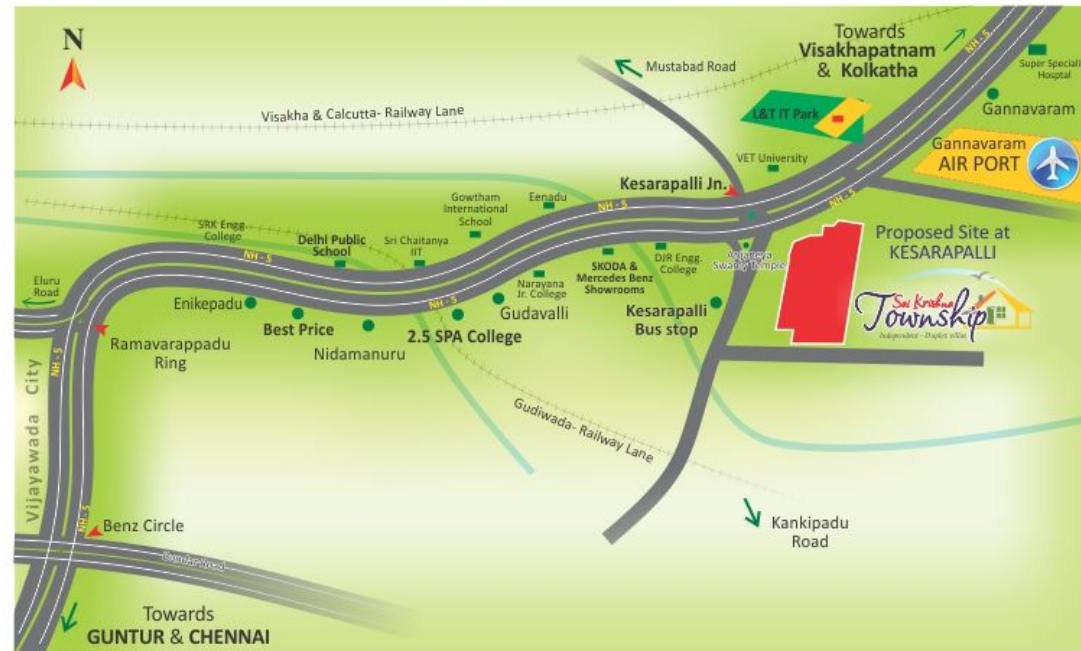

KRUSHNA SAI HOUSING PVT. LTD.,

59A-3-3/2B, Chalasani Mansion, 2nd Floor, Opp. Executive Club, P&T New Colony
VIJAYAWADA-8. Ph : 0866-2476799, 3259699 e-mail: krishnasaihousing@yahoo.in
Visit us : krushnasaihousing.com

concepts - 9440159707